

**TYPICAL KERB PROFILE:  
SEMI-MOUNTABLE TYPE**  
SCALE 1:5

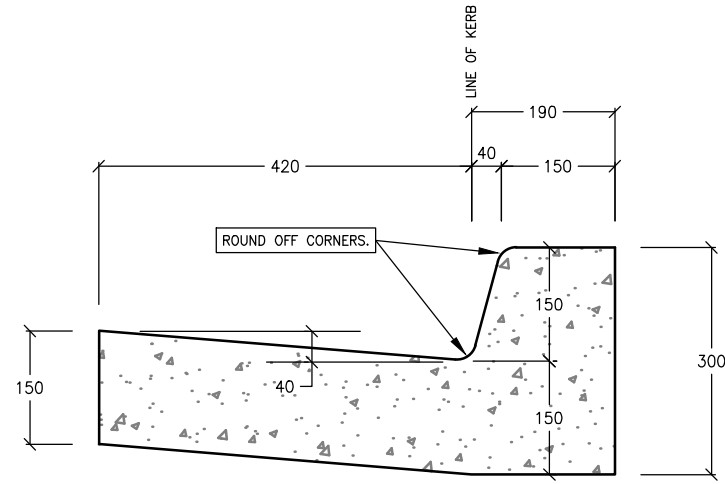

**SECTION B-B  
TYPICAL KERB & GUTTER  
PROFILE: BARRIER TYPE**  
SCALE 1:5

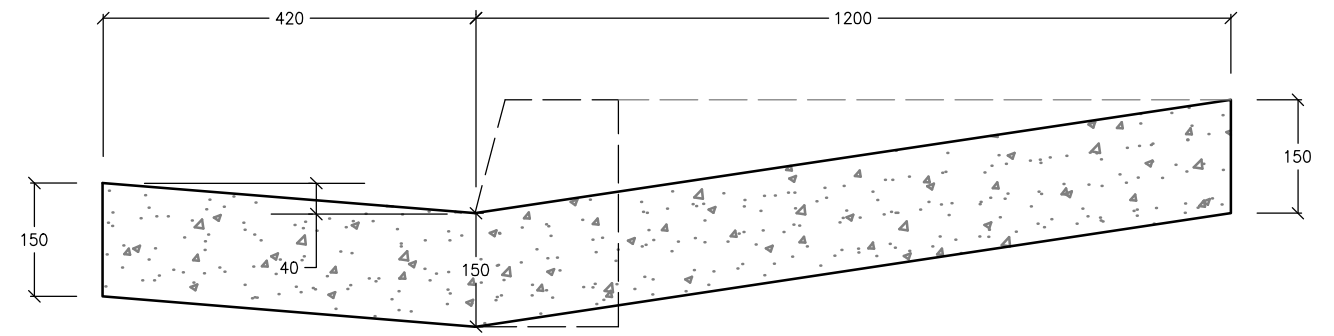

**SECTION C-C  
TYPICAL LAYBACK CROSS SECTION**  
SCALE 1:5

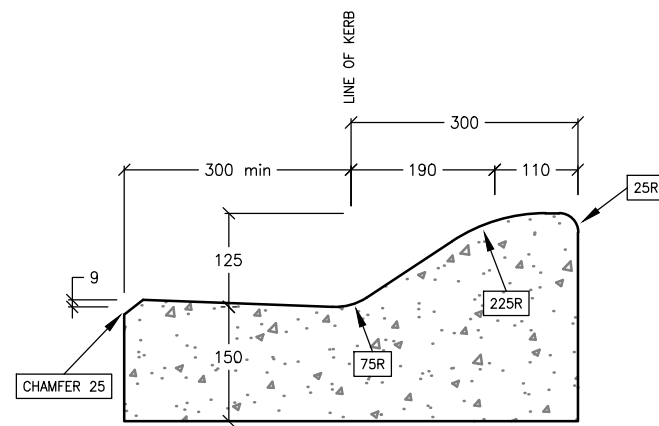

**TYPICAL KERB & GUTTER  
PROFILE: ROLL TYPE**  
SCALE 1:5

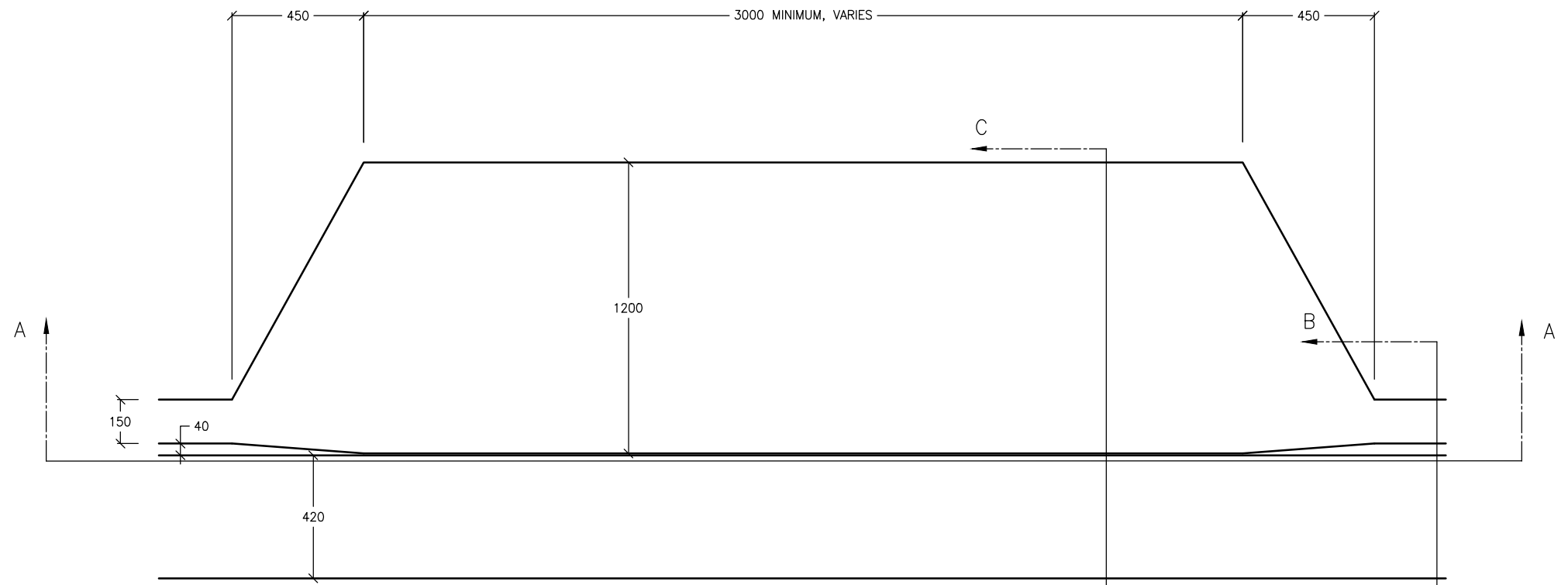

**PLAN  
SCALE 1:10**

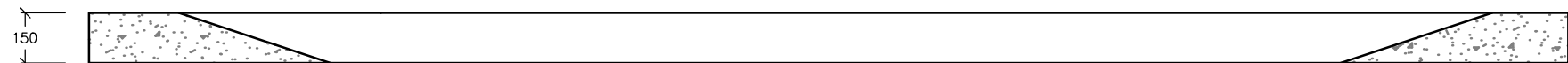

**SECTION A-A  
TYPICAL LAYBACK ELEVATION FOR BARRIER  
KERB AND GUTTER**  
SCALE 1:10

**NOTES:**

1. ALL DIMENSIONS IN MILLIMETRES.
2. ALL CONCRETE TO BE MINIMUM 25MPa.
3. NO LIP TO BE PLACED IN LAYBACK AT GUTTER LINE.
4. RESIDENTIAL LAYBACKS TO BE 150 THICK WITH ONE LAYER SL72 MESH, 50 TOP COVER.
5. COMMERCIAL/INDUSTRIAL LAYBACKS TO BE 200 THICK WITH 2 LAYERS SL72 MESH TOP AND BOTTOM, 50 COVER.

CONSULTANT	REV	DESCRIPTION	INITIALS	DATE	SCALES (A1)	SURVEYED	CHECKED	PROJECT
	A	ISSUED FOR APPROVAL	----	12-06-98	1:10 0 0.1 0.2 0.3 0.4 0.5 Metres	—		BRC STANDARD KERB & GUTTER & LAYBACK DETAILS
	B	LAYBACK INCREASED TO 1m DEEP	----	23-03-03	1:20 0 0.2 0.4 0.6 0.8 1.0	DRAWN MC	TECHNICAL SERVICES MANAGER	DESCRIPTION
	C	LAYBACK PROFILE ALTERED (STEP REMOVED)	----	11-11-04	1:500 0 5 10 15 20 25	DESIGN —		PLAN, SECTIONS & ELEVATIONS
	D	SEMI MOUNTABLE KERB PROFILE AMENDED	—	26-04-05	1:750 0 7.5 15 22.5 30 37.5	DATE 21-09-23	DIRECTOR ENGINEERING SERVICES	DWG No. EN7876
	E	KERB LINE AMENDED	—	30-08-11	1:1000 0 10 20 30 40 50	DATUM AHD		SHEET No. 01
CHECKED	F	LAYBACK DEPTH INCREASED FROM 1000 TO 1200	MC	04-08-17				REV. G
APPROVED	G	LAYBACK 3000 WIDE, NOTES & DRAFTING UPDATE	MC	21-09-23				

